

HOW TO PHOTOGRAPH YOUR ROOM FOR E-DESIGN

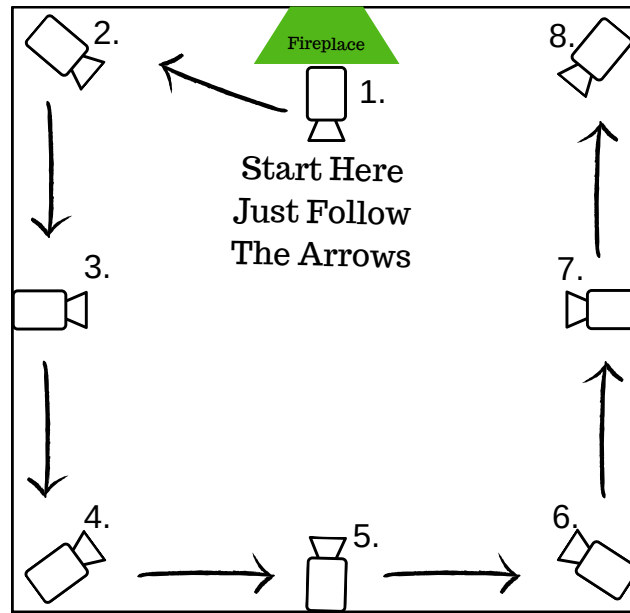

TIPS

1. Take photos during the day or with lights on.
2. You can take pictures vertically or horizontally.
3. Take pictures as clear as possible.
4. Upload pictures via E-Design Questionnaire.

HOW TO MEASURE YOUR ROOM FOR E-DESIGN

TIPS

1. Draw a floorplan of your room include windows, doors, openings, fireplaces & built-ins.

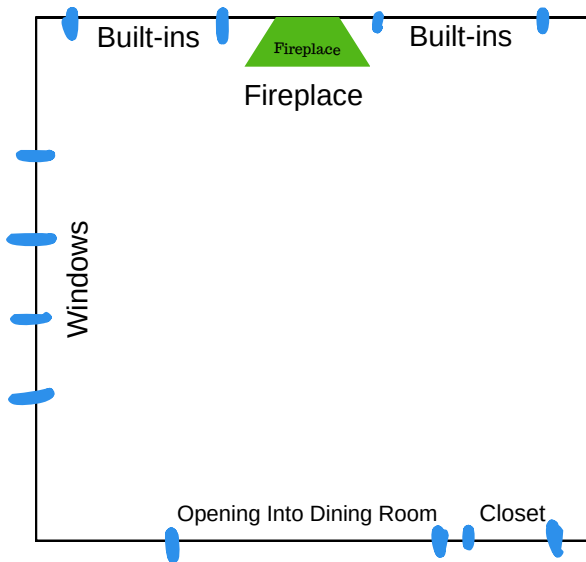

2. Measure the length of your room down the center & do the same for the width of your room. 14' indicates feet / 3" indicates inches.

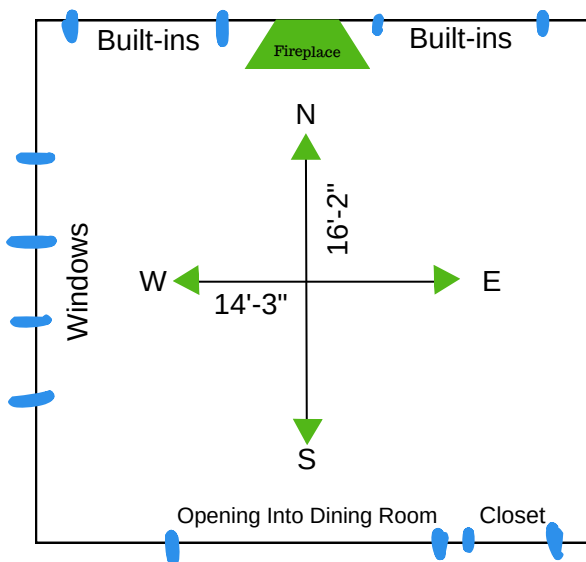

HOW TO MEASURE YOUR ROOM FOR E-DESIGN

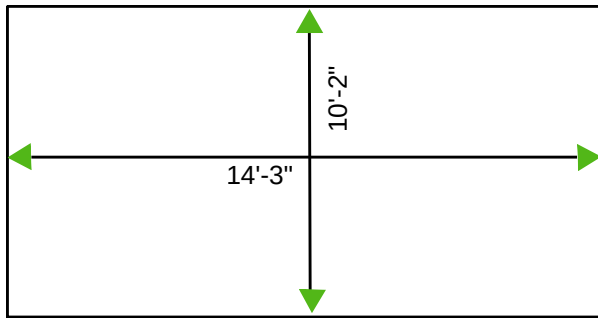

Walls

3. Measure each individual wall in feet & inches.

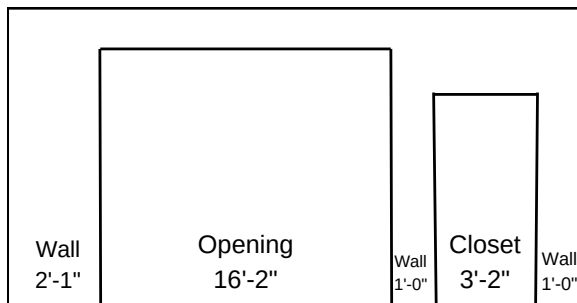

4. Draw in the placement of all wall features such as doors, windows, built-ins, openings, etc. & measure size of each item.

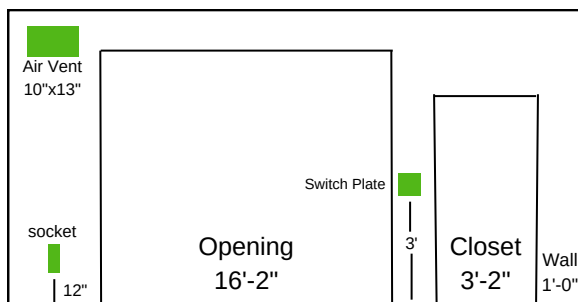

5. Draw in any key details & measure size of each item. Locate & indicate sconces, electrical sockets, light switches, air vents, & wainscoting.

Please repeat steps 3, 4 & 5 for each wall.

Draw Your Room & Walls. Take a picture of your drawings & upload via E-Design Questionnaire.



DRAW YOUR ROOM HERE



DRAW YOUR WALL HERE